

# Automotive Tools.

Be a MATADOR.



## Content Automotive tools.

Page Article group



### Bumping tools.

249	Single Bumping Hammer
249	Pick Hammer
249	Cross Pein and Finishing Hammer
249	Planishing Hammer
249	Balanced Ding Hammer
249	Double Bumping Hammer
250	Dollies and Anvil Blocks
250	Body and Fender Tools
251	Light metal hammer
251	Body Work File Holder
251	Spot Weld Drill HSS-E Co 5
252	Punch and Flange Tool
252	Car Body Chisel
252	Nozzle Adjusting Tool
253	Door panels removal tool
253	Plastic Wedge
253	Trim & Panel Removal Kit



### Tools for brakes / wheels / chassis

254	Four Way Rim Wrench for cars
254	Four Way Rim Wrench for trucks, forged
255	SlimPOWER Impact Sockets
255	Special Flat Nose Pliers
255	Tyre Levers
256	Tyre Levers
256	Pry Bars
256	Set of Pry Bars, 4 pcs
256	Camber adjustment tool
257	Brake Adjusting Spanner
257	Brake Caliper Brush
257	Brake Caliper File
257	Spreader for shock absorbers



### Hose clamps.

258	Hose Clamp Pliers for torque wrenches
-----	---------------------------------------



### Valves and piston rings.

258	Suction Valve Grinder Stocks
258	Piston Ring Compressors

Page Article group



### Battery and cooling system.

259	Battery Terminal Brush
259	Antifreeze Tester
259	Voltage Tester



### Oil service.

260	Special Drain Plug Wrenches
260	Universal Strap Wrenches Eco
260	Universal Strap Wrenches Pro
261	Universal Oil Filter Wrench
261	Cartridge Wrench for trucks
261	Oil Filter Sockets



### Spark- and glowplugs.

262	Spark Plug Wrench with handle
262	Spark Plug Wrench with tommy bar
263	Spark Plug Wrench (swivelling long type)
263	Spark Plug Pliers
263	Spark Plug Brush
264	Spark Plug Sockets 10 (3/8)
264	Spark Plug Sockets 12.5 (1/2)



### Special sockets.

265	Socket for injection nozzles
265	Socket with slot
265	Crown socket for pre-chambers



## MATADOR bodywork and bumping tools. Top-grade industrial quality. Blow by blow.



Precisely forged.

Numerous dollies for all types of bodywork.

No split-off due to chamfered edges.



For the repair of all metal parts.

Durable quality.

Bodywork and bumping tools are essential for the repair of all metal parts.

All MATADOR bodywork and bumping tools are precisely forged and manufactured in Germany and meet our strict quality standards.

The product range of MATADOR includes all types of hammers for body work as well as numerous dollies, anvil blades and body and fender tools.

As a basic equipment the MATADOR tool kits „L“ and „XL“ with all major bodywork tools have proven their value. They are a must have for every workshop.

MATADOR bodywork and bumping tools have been tried and tested many times. For many years, numerous OEMs and their workshops come to trust the quality of the MATADOR body work tools.



## Single Bumping Hammer

- With ash handle
- Blue lacquered
- With ground faces
- Material: Hardened / tempered steel

Art. Code	l mm	mm	l mm	g	
0732 0001	165	28	330	710	1



## Pick Hammer

- Short pattern
- With ash handle
- Blue lacquered
- With ground faces
- Material: Hardened / tempered steel

Art. Code	l mm	mm	l mm	g	
0732 0003	137	37	300	360	1



## Cross Pein and Finishing Hammer

- With ash handle
- Blue lacquered
- With ground faces
- Material: Hardened / tempered steel

Art. Code	l mm	mm	l mm	g	
0732 0004	160	40	300	405	1



## Planishing Hammer

- With two faces
- With ash handle
- Blue lacquered
- Art. Code 0732 0007: short pattern with one milled cross-hatched face and one smooth square face
- Material: Hardened / tempered steel

Art. Code	l mm	mm	l mm	g	
0732 0006	105	32/25	290	305	1
0732 0007	100	40/35	310	395	1



## Balanced Ding Hammer

- With ash handle
- Blue lacquered
- With ground faces
- Material: Hardened / tempered steel

Art. Code	l mm	mm	l mm	g	
0732 0008	155	40/31	310	495	1



## Double Bumping Hammer

- With ash handle
- Blue lacquered
- With ground faces
- Material: Hardened / tempered steel

Art. Code	l mm	mm	l mm	g	
0732 0010	160	31	310	540	1



## ■ Dollies and Anvil Blocks

- Drop forged
- Blue lacquered
- With ground faces
- Material: Hardened / tempered steel



Art. Code	mm	g	
0734 0001	72 x 55 x 63 („VW“)	1100	1



Art. Code	mm	g	
0734 0002	130 x 55 x 36	950	1



Art. Code	mm	g	
0734 0003	100 x 40 x 80 x 70 x 62	1370	1

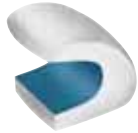

Art. Code	mm	g	
0734 0004	70 x 54 x 68	1300	1



Art. Code	mm	g	
0734 0005	80 x 60 x 33	1050	1



Art. Code	mm	g	
0734 0007	120 x 58 x 23	760	1



Art. Code	mm	g	
0734 0010	60 x ø56 x ø56 („Diabolo“)	750	1



Art. Code	mm	g	
0734 0011	130 x 48 x ø58	930	1



Art. Code	mm	g	
0734 0015	125 x 55 x 25	1100	1



## ■ Body and Fender Tools

- Drop forged
- Blue lacquered
- With ground faces
- Material: Hardened / tempered steel



Art. Code	mm	g	
0735 0001	400 x 25 x 58	1050	1



Art. Code	mm	g	
0735 0003	500 x 58	2200	1



Art. Code	mm	g	
0735 0004	270 x 30 x 18	550	1



Art. Code	mm	g	
0735 0005	300 x 50	800	1



Art. Code	mm	g	
0735 0006	390 x 25 x 58	1000	1

## Light metal hammer

- Perfect for all kind of bodywork
  - Cylindrical pattern
  - With ash handle
- Material: Aluminium



Art. Code	b mm	l mm	g	
0733 0350	40	105	350	1

## Spot Weld Drill HSS-E Co 5

- For burr-free drilling and center punching
- Extreme high precision
- With center tip as ground point
- For sheet steel, brass, aluminium, zinc, copper, plastic sheets etc.
- Average tolerance: h8

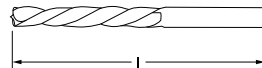

Art. Code	mm	l mm	g	
0862 0004	8	80	10	10



## Body Work File Holder

- For quick removing of high spots
- Mill-cut body file
- Material: Cast aluminium

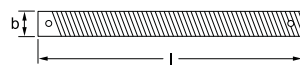
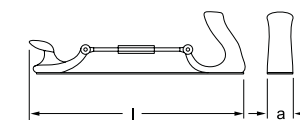

Art. Code	b mm	a mm	l mm	g
0740 0001		30	350	820
0740 0003		35	350	270
0740 0006		35	350	270



With turnbuckle for easy adjustment

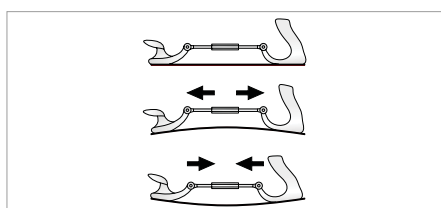

For flat and curved applications

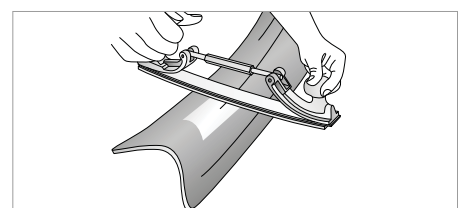

For comfortable use with two hands

## ■ Punch and Flange Tool



- Labor saving tool, crimps edges on sheet metals up to 1mm thickness
- With rotating head, allows to punch holes in panels also
- Single-handed, low-force operation
- Single hand push-button release
- Self opening
- Hardened jaws
- Crimping capacity 13 mm
- Jaw width 22 mm

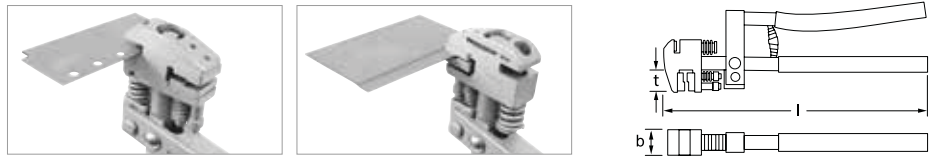

Art. Code	t mm	b mm	l mm	g	
0741 0001	20	22	290	1200	1

## ■ Car Body Chisel



- For cutting sheet metal, welding spots, welding grooves etc.
- With hand guard, blade size 7 x 26 mm
- Self hardening steel

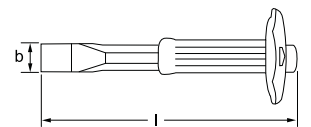

Art. Code	b mm	l mm	g	
0846 0001	26	240	150	1
0846 0091	Handschutz für Karosserie-Blechmeißel		9,5	1

## ■ Nozzle Adjusting Tool



- Telescopic handle with Neodym magnetic head
- Capacity 500 g
- 6 mm diameter
- For adjusting the nozzles of the washing system, can be used to demonstrate the jet direction to the window, adjusting needle and protective cap
- With pocket clip
- Material: Special steel
- Surface: Zinc plated

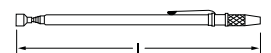

Art. Code	l mm	g	
0863 0001	150 - 660	25	10

## ■ Door panels removal tool

- Zum schnellen und einfachen Ausbau von Türverkleidungen
- Maulöffnung 6 mm
- Material: Spezialstahl

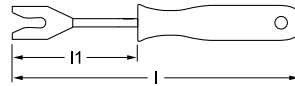

Art. Code	l mm	l1 mm	g	
0842 0001	176	60	90	1

## ■ Plastic Wedge

- For fast and easy removing of mouldings and door covering
- Avoids damage of lacquered surfaces
- One side open / bent (for loosening door / cover clips), one side with flat pin to fix plastic clips

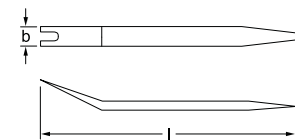

Art. Code	b mm	l mm	g	
0843 0001	20	210	25	1



## ■ Trim & Panel Removal Kit

- Professional trim and panel removal kit
- Plastic tools allow you to dismantle upholstery and plastic panels without scratching or damaging painted, leather, chrome-plated and other surfaces
- For fast and convenient trim panel, upholstery and car interior elements removal (dashboard items, radios, door cards, moulding, etc.)
- Also suitable for household for many applications



Art. Code	l mm	g	
0843 9050	160 - 200	100	1

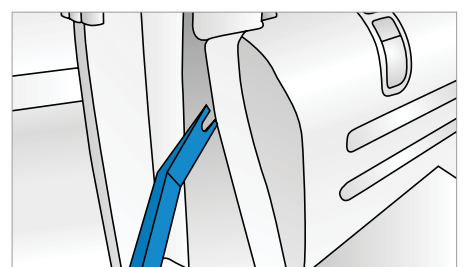
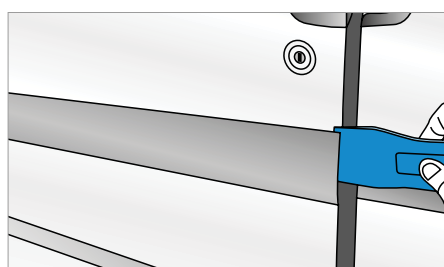
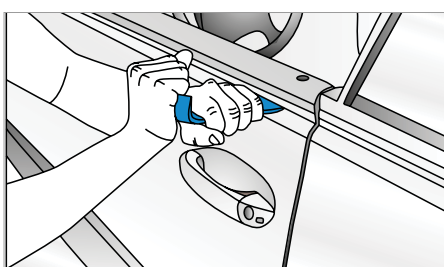



## Tools for brakes / wheels / chassis. Automotive Tools.



### ■ Four Way Rim Wrench for cars



- Welded version
- 6 point
- With MATADOR SmartDrive profile
- Material: Chrome Vanadium
- Surface: Matt chrome finished

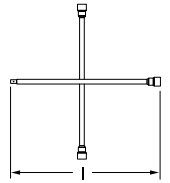

Art. Code	mm	"	l mm	g	
0350 1001	17 x 19 x 21	1/2	380	1300	5



### ■ Four Way Rim Wrench for trucks, forged



- With forged middle part
- High capacity, tested up to 2,000 N·m
- Arms and middle part hardened, polished heads
- Standards: DIN 3119 / ISO 6788,
- Material: Chrome Vanadium
- Surface: Matt chrome finished

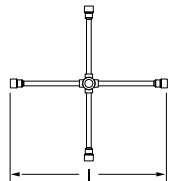

Art. Code	mm	"	l mm	g	
0356 0002	24 x 27 x 32 x 3/4"	15/16 x 1.1/16 x 1.1/4 x 3/4"	750	5750	1

## SlimPOWER Impact Sockets



- For wheel mounting and dismounting
- Allow up to 6 times longer service life in comparison to other impact sockets
- With plastic sleeve to protect the rings when screwing the wheel nuts
- For use with impact wrenches
- Exchangeable plastic head with color code

- Standards: DIN 3121 / ISO 1174
- Material: Chrome Molybdenum

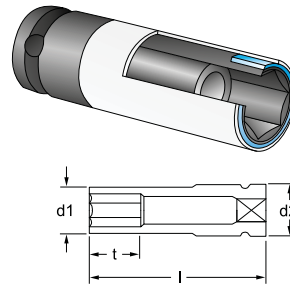
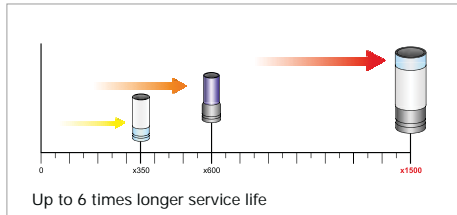

Art. Code	mm	t mm	d1 mm	d2 mm	l mm	g
7481 1170	17	20	26	25,5	86	220
7481 1190	19	20	28	27,5	86	240
7481 1210	21	20	30	29,5	86	270

## Special Flat Nose Pliers

- With groove
- Enables the damage-free removal of wheel nut caps on aluminium rims
- Also suitable for flat protections etc.
- Jaw length / width: 85 / 9 mm

- Material: Chrome Vanadium

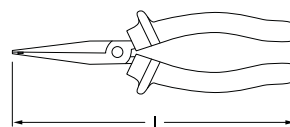

Art. Code	l mm	l"	g
0585 0014	160	8	200

## Tyre Levers

- Heavy-duty version
- Especially for trucks
- For tire installation and removing
- For steel and aluminium rims
- Tips hardened

- Material: Chrome Vanadium
- Surface: Matt chrome finish

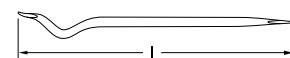

Art. Code	l mm	l"	g
0753 0002	400	16	620
0753 0003	500	20	790
0753 0004	600	24	970

## ■ Tyre Levers



- Double T-profile for high stability
- Drop forged
- For tire installation and removing, for steel and aluminium rims, also suitable for general purposes

- Material: Chrome Vanadium
- Surface: Matt chrome finish

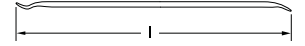

Art. Code	l mm	l"	g	
0754 0002	400	16	425	5
0754 0003	500	20	550	5
0754 0004	600	24	750	5

## ■ Pry Bars



- With octagonal shank

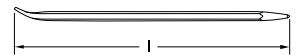

Art. Code	l mm	l"	g	
0757 0001	400	16	550	5

## ■ Pry Bars



- Pry Bar Round Head
- For difficult applications

- Material: Chrome Vanadium
- Surface: Matt chrome finish

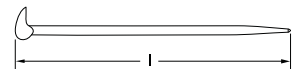

Art. Code	l mm	l"	g	
0758 0001	410	20	450	5

## ■ Set of Pry Bars, 4 pcs



- For many applications
- For repair work on trucks (for bearing bushings, cab bearings, cardan shaft slackness etc.)
- Solid 4-pt. blade for heavy use
- With plastic handle

- Material: Chrome Molybdenum
- Surface: Black coated

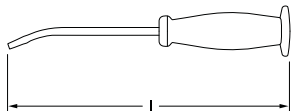

Art. Code	l mm	l"	g		
0759 0010	4-teilig	200, 300, 450, 600	7.3/4, 12, 18, 23.1/2	1600	1

## ■ Camber adjustment tool



- 12,5(1/2) / 18 MM



Art. Code	l mm	l"	g	
0202 0180	--	--	200	1

## Flare Nut Wrenches

- For screwed connections on brake lines
- To reach the screws at front and back axle, reinforced design
- With 6-pt and straight slot
- Material: Chrome Vanadium
- Surface: Matt chrome finish

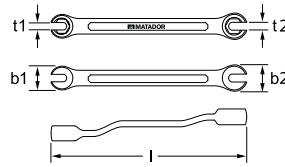

Art. Code	mm	Ausführung	t1 mm	t2 mm	b1 mm	b2 mm	l mm	g	
0250 0001	10 x 12	straight type	7,0	8,5	20,5	22,3	150	80	10
0250 0002	10 x 11	bent type	7,0	8,5	20,5	22,3	175	75	10

## Brake Caliper Brush

- For removal of brake dust and dirt from the caliper shaft
- For disk brakes, slim design
- With plastic handle and suspension hole

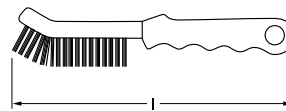

Art. Code	l mm	l"	g	
0852 0001	225	9.1/2	60	10

## Brake Caliper File

- For removal of brake dust, dirt und rust from the caliper shaft
- For disk brakes
- Cut: gross
- Coarse level cut on one side (to prevent damage of dust boot)
- With plastic handle and suspension hole
- Bevel toothed, 12 mm width
- Material: Special steel

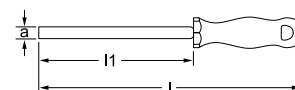

Art. Code	a mm	l1 mm	l mm	l"	g	
0854 0001	12	155	265	10.1/2	110	10

## Spreader for shock absorbers

- For spreading of the front shock absorber tube from the wheel bearing housing
- Blade black
- For VW, Audi, Ford, Peugeot etc.
- Material: Chrome Vanadium
- Surface: Matt chrome finish

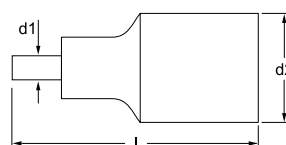

Art. Code	d1 mm	d2 mm	l mm	g	
4078 0031	8,2 x 5,5	23	48	66	10

12,5 mm 1/2

## Tools for hose clamps. Automotive tools.

### ■ Hose Clamp Pliers for torque wrenches

10 mm 3/8"



- With 10 mm (3/8")-drive for the use with torque wrenches
- Enables clamping and / or compressing of hose clamps
- Suitable for new stainless steel hose clamps
- With blade in plastic handle
- Very light and robust aluminium construction

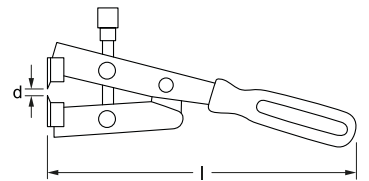

Art. Code	d mm	l mm	l "	g	
0551 0001	0,0 - 45,0	270	10.1/2	570	1

## Tools for valves and piston rings. Automotive tools.

### ■ Suction Valve Grinder Stocks



- For grinding the valve seating
- Both ends with rubber cup
- With wooden shaft

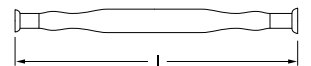

Art. Code	mm	l mm	g	
0419 0001	16 x 21	200	63	1
0419 0002	28 x 34	200	63	1

### ■ Piston Ring Compressors



- For inserting the piston with ring into the cylinder, stepless adjustment, with key,
- High grade tool steel

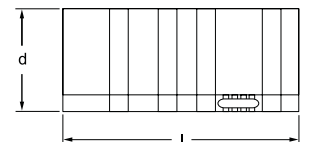

Art. Code	Ø d mm	Ø d "	l mm	l "	g	
0567 0001	40 - 75	1.1/2 - 3	50	2	90	1
0567 0002	60 - 125	2.1/4 - 5	80	3.1/8	320	1
0567 0003	90 - 175	3.1/2 - 7	80	3.1/8	360	1
0567 0004	90 - 175	3.1/2 - 7	165	6.1/2	680	1

# Tools for battery and cooling system. Automotive tools.

## ■ Antifreeze Tester

- Large, easy-to-read scale in a compact and heavy duty instrument
- Automatic temperature compensation allows accurate reading at all temperatures
- Fast, bubble free intake of fluid samples avoids measurement errors due to air bubbles
- Automatic air-lock prevents fluid loss and air bleed
- Tests all ethylene glycol antifreeze coolants

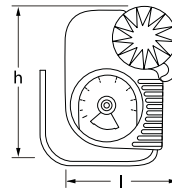

Art. Code	h mm	l mm	g	
0806 0002	131	110	130	1

## ■ Battery Terminal Brush

- For cleaning battery terminals
- In plastic box

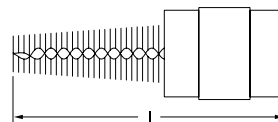

Art. Code	l mm	g	
0783 0001	120	20	10

## ■ Voltage Tester

- For checking lightning and ignition systems
- Testing range 6 to 24V
- With tip, protective cap, fixed cable and clip
- blade Chrome Vanadium steel

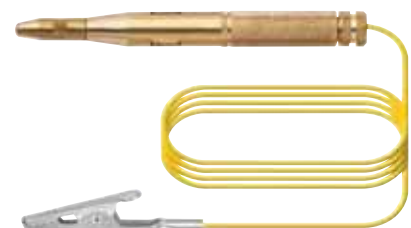
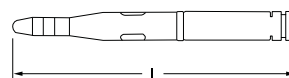

Art. Code	l mm	g	
0633 0001	120	70	10

## Tools for the oil service. Automotive tools.

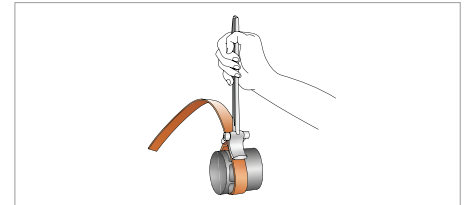
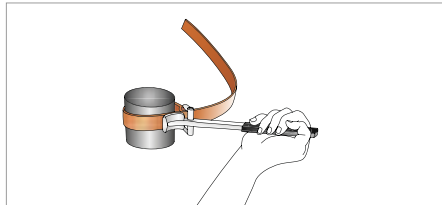
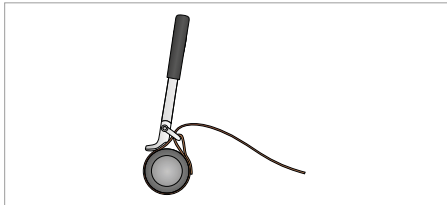

### Special Drain Plug Wrenches

- To loose and tight the filler plug and oil drain
- For the oil filter and oil drain plugs on gearbox, differential and oil pan

- Material: Chrome Vanadium
- Surface: Matt chrome finish

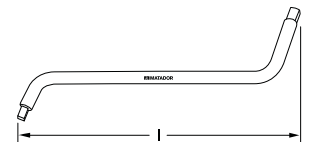

Art. Code	mm	l mm	g	
0266 0001	8 x 10	240	250	10

### Universal Strap Wrenches Eco

- For oil filters and other round shaped bodies
- With cotton textile tape, rubber coated, nonskidding
- Cushion grip handle

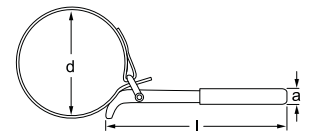

Art. Code	d mm	g	
0425 0001	max. 170	280	1
0425 0002	Ersatzband	30	1

### Universal Strap Wrenches PRO

- For oil filters and other round shaped bodies
- With forged handle, heavy-duty construction
- Especially for commercial vehicles and agricultural machinery
- With cotton textile tape, rubber coated, nonskidding

- Material: Chrome Vanadium
- Surface: Matt chrome finish

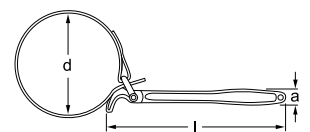

Art. Code	d mm	g	
0426 0001	max. 240	600	1
0426 0002	Ersatzband	40	1

## ■ Universal Oil Filter Wrench

10 mm 3/8

- For loosening oil filters
- Suitable for oil filters and air filters
- For cartridges- Ø of approx. 80 - 130 mm

- Material: Special steel
- Surface: Black phosphated

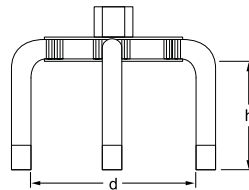

Art. Code	mm	"	mm	d mm	h mm	g	
0428 0003	10	3/8	21	80 - 130	50	680	1

## ■ Cartridge Wrench for trucks

1/2 12,5 mm

- Heavy pattern, for loosening the granulates cartridge on commercial vehicles with compressed air dryer

- Material: Special steel
- Surface: Black phosphated

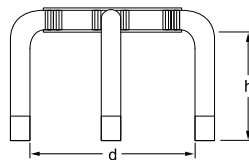

Art. Code	mm	"	d mm	h mm	g	
0428 0145	12,5	1/2	80 - 150	65	940	1

## ■ Oil Filter Sockets

10 mm 3/8

- Fits all standard oil filter cartridges



Art. Code	mm	"	mm	mm	mm	mm	g
0429 0001			21	14-kt	74	84	175



## Tools for spark and glow plugs.

MATADOR. One of the leading suppliers for the automotive industry.



### ■ Spark Plug Wrench with handle

- Universal spark plug wrench for most applications
- With swivelling handle

- Material: C35 hardened
- Surface: Matt chrome finish

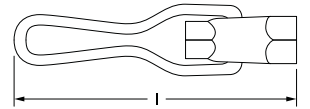

Art. Code	mm	"	mm	"	l mm	g	
0366 0001	16	5/8	20,8	13/16	155	130	5

### ■ Spark Plug Wrench with tommy bar

- Universal spark plug wrench for most applications
- With tommy bar 10 mm Ø

- Material: C35 hardened
- Surface: Matt chrome finish

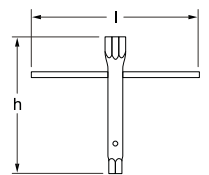

Art. Code	mm	"	mm	"	l mm	l mm	g	
0366 0002	16	5/8	20,8	13/16	150	200	290	5

## ■ Spark Plug Wrench (swivelling long type)

10 mm 3/8

- With ball joint for difficult accessible spark plugs
- With square drive as per DIN 3120 C10 / ISO 1174
- Standards: DIN 3120 / ISO 1174
- Material: C35 hardened
- Surface: Matt chrome finish

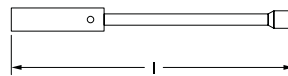

Art. Code	mm	"	mm	"	l mm	g	
0367 0016	16	5/8	10	3/8	270	285	5

## ■ Spark Plug Pliers

2K

- For installing and removing of spark plug sockets
- Usable for warm engine and switched off ignition
- Long, straight, flat-round jaws
- With dual component handle

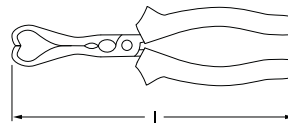

Art. Code	l mm	l "	g	
0568 2001	205	8	230	1

## ■ Spark Plug Brush

- For cleaning of electrodes and contacts on spark plugs
- Special corrugated brass wire bristles
- 3 rows
- Trim size 15 mm
- Wooden body



Art. Code	l mm	g	
0781 0001	150	10	10

## ■ Spark Plug Sockets 10 (3/8)



- For spark plugs
  - With rubber or magnet
  - For hand operation
  - Inner square drive acc. to DIN 3120 - C 10 / ISO 1174
  - With six point profile
  - With non-slip cross knurling
- Standard: DIN 3124 / ISO 2725-1
  - Material: Chrome Vanadium
  - Surface: Super-Chrom

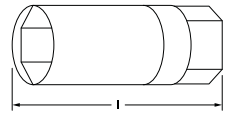

Art. Code	mm	"			l mm	g	
3081 0140	14	9/16	Rubber type		65	100	10
3081 0160	16	5/8	Rubber type		65	100	10
3081 0180	18	11/16	Rubber type		65	110	10
3081 0208	20,8	13/16	Rubber type		65	120	10
3081 1160	16	5/8	Magnetic type		70	120	10
3081 1208	20,8	13/16	Magnetic type		70	140	10

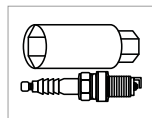

## ■ Spark Plug Sockets 12.5 (1/2)



- For spark plugs
  - With rubber or magnet
  - For hand operation
  - Inner square drive acc. to DIN 3120 - C 12.5 / ISO 1174
  - With six point profile
  - With non-slip cross knurling
- Standard: DIN 3124 / ISO 2725-1
  - Material: Chrome Vanadium
  - Surface: Super-Chrom

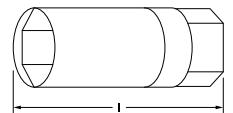

Art. Code	mm	"			l mm	g	
4081 0160	16	5/8	Rubber type		65	100	10
4081 0180	18	11/16	Rubber type		65	110	10
4081 0208	20,8	13/16	Rubber type		65	130	10
4081 1160	16	5/8	Magnetic type		70	170	10
4081 1208	20,8	13/16	Magnetic type		70	185	10

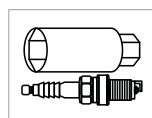

# Special sockets.

## ■ Socket for injection nozzles

- With notch (35 x 35 mm) for screwing of diesel injection nozzles without damaging the return pipe
- 12-pt
- Material: Special steel
- Surface: Black phosphated

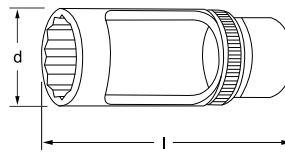

12.5 mm 1/2

Art. Code	mm	Schlitz	d mm	l mm	g	
4081 0060	27	35 x 35	27	81	375	1

## ■ Socket with slot

- SW 22
- Material: Special steel
- Surface: Black phosphated

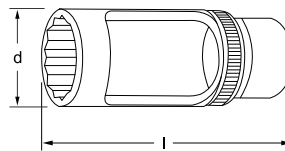

12.5 mm 1/2

Art. Code	mm	Schlitz	d mm	l mm	g	
4095 0220	22	--	--	--	500	1

## ■ Crown socket for pre-chambers

- Grooved Socket for pre-chambers
- With 58 teeth
- Material: Special steel
- Surface: Black phosphated

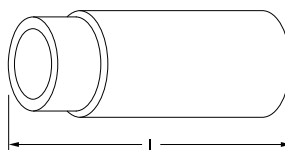

12.5 mm 1/2

Art. Code	mm	l mm	g	
7053 0006	58	60	215	1